



MonoSLEEVE™

Operations Manual



Thank you for purchasing Analytical Sales and Services **MonoSLEEVE™** Column Heater system. This manual will guide you through setup, and operation of your new heater.

Safety Warnings:

All heater systems are designed for use by properly trained individuals following Good Laboratory Practices who have read and understand this entire manual.

CAUTION: MonoSLEEVE's are finely tuned instruments. The flexible heating units used by this controller are sensitive and delicate devices that when used correctly will offer you years of reliable service. **Sleeves must NOT be bent backward or excessively flexed in any direction.** Doing so could possibly break the thin wires imbedded within the sleeve and cause the heater to stop heating properly.

CAUTION: The temperature controller must be operated away from liquids so as not to accidentally spill solvents on the top cover. Do not immerse or operate any part of the Column Heater in liquids. In the event of solvent leakage, wipe sleeve clean before further use.



Contents

Safety	2
Product Specifications	3
General Inspection	3
System Setup	6
Operational	7
Use and Care	7
External Control	8
GUI Interface	9

© 2019 Analytical Sales and Services, Inc.
All rights reserved. Unauthorized duplication
without express written permission by Analytical
Sales and Services, Inc. is prohibited by law .

Manufactured by
Analytical Sales and Services, Inc.

Product Specifications

Power Requirements:	90-264 VAC, Internal Conversion to 24 VDC
Heating Range:	5°C above ambient to 100°C
Heating Elements:	12-100 Watt, 24 VDC Rated
Heater Accuracy:	+/- .5°C
Controller Accuracy:	+/- 0.1°C
Calibration Points:	45°C set within HotSLEEVE Plus or AgileSLEEVE Plus

Environmental

Operating temperature: 32° to 122° F ambient (0° to 50° C)

Operating humidity: No greater than 75% relative humidity (non-condensing)

This manual covers the following controlled heater products:

- MonoSLEEVE
- HotSLEEVE PLUS - 5, 10, 15, 25, 30 cm lengths
- AgileSLEEVE PLUS - All lengths and I.D.'s

General Inspection

Unpacking and Inspection

Verify that the column heater package contains the following:

- MONOSLEEVE Controller, 24VDC Power Supply, Power Cord, Manual, GUI Software, Green Remote Plug, USB 2.0 Cable, and Test Data Sheets if in kit form.

Please notify Technical Service if the Column Heater has any missing or damaged parts.
Contact numbers: 973-616-0700, Fax 973-616-0133.

The MonoSleeve™ controller is used for applications which require single heating zones. Used in conjunction with the **Hot Sleeve Plus™** or **AgileSleeve PLUS™** heater, it maintains one channel.



The MONOSLEEVE controller is designed for use in analytical format liquid chromatography applications only.



The actual temperature and the user selected set point are displayed on the front of the temperature controller. Both the user set point and the actual temperature are in full display by pressing the Menu button.

The MonoSLEEVE will function with HotSLEEVE PLUS™ and AgileSLEEVE PLUS™ heaters only. Each smart heater has a unique blue banding on the cord indicating built-in Smart Chip sensing.

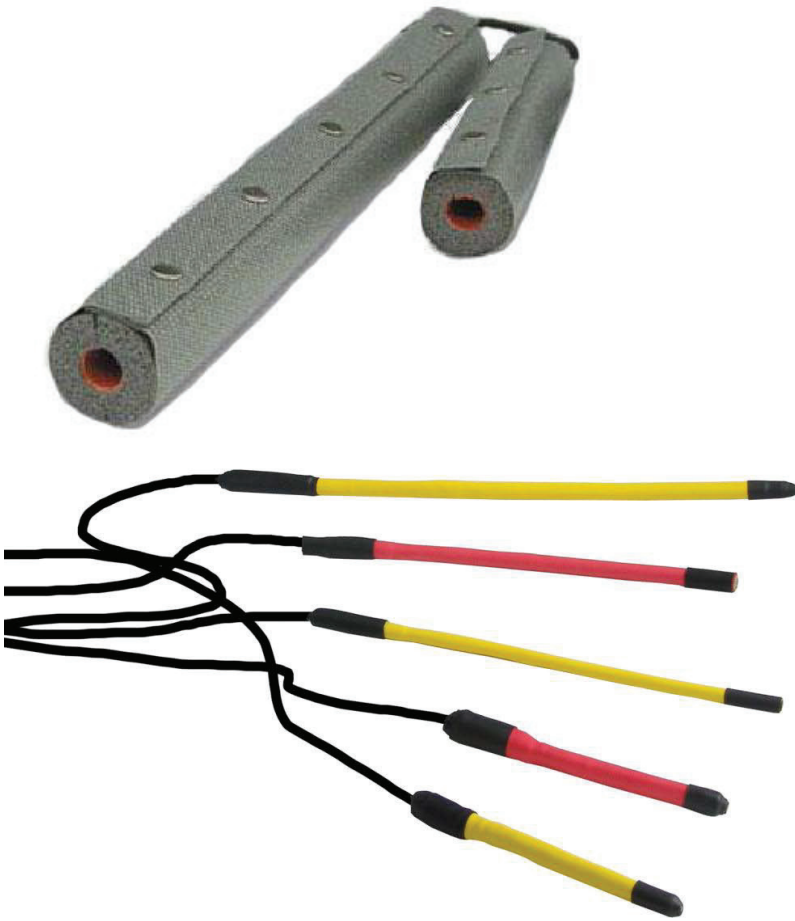

NOTE:

MonoSLEEVE **will only accept** HotSLEEVE PLUS and AgileSLEEVE PLUS heaters with new “Plug and Play” technology. Heaters are not “Hot Swappable” while unit is powered on.

Setup

Make certain that the temperature controller is turned off. Insert the power cord into the main receptacle, and then the plug into the supplied 24VDC Desktop Power Supply. Last, insert the heating plug into the back of the controller marked Load Circuit shown below.

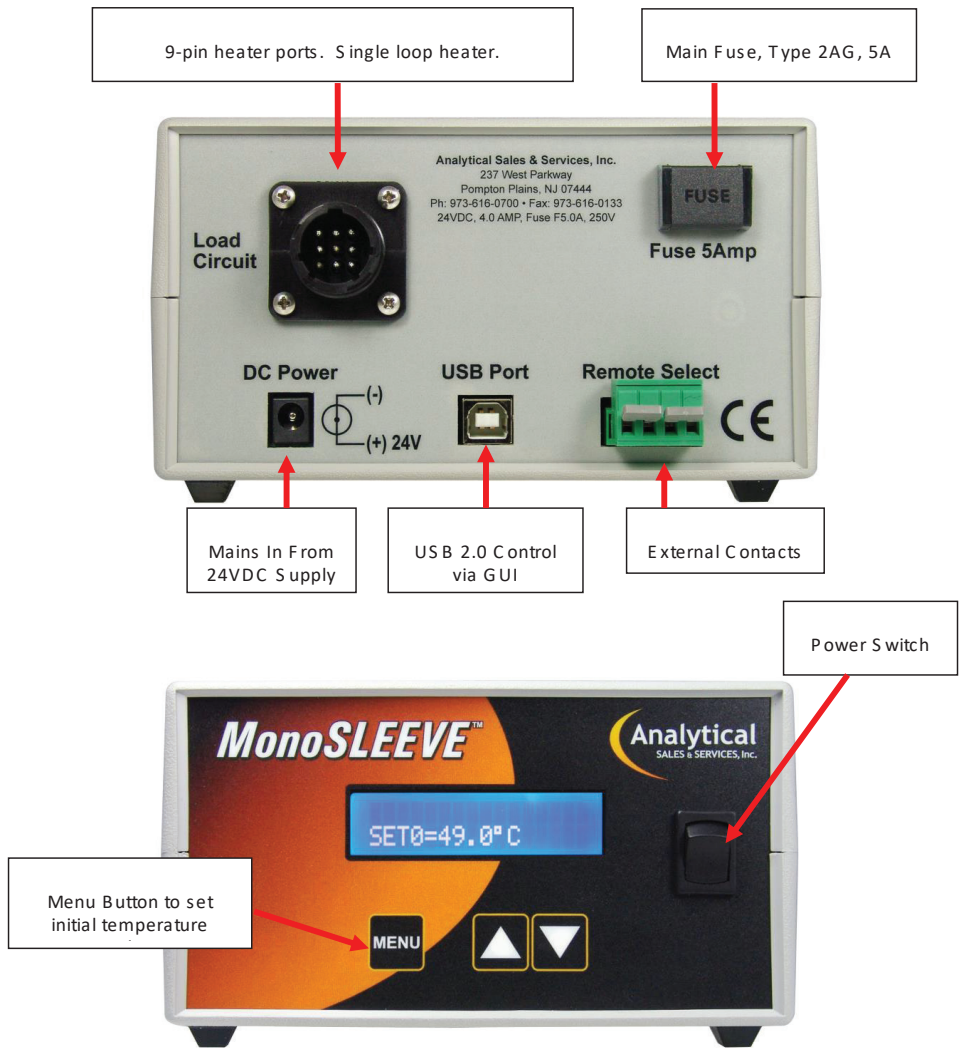

Turn the Column Heater on. The temperature controller will perform a self diagnostic test upon power-up. If, after powering up, the display indicates something other than reasonable temperature values, notify Customer Service for further action.

The Column Heater contains one fuse. If the display does not appear to illuminate at all, check the main fuse.

Note that the LCD display on the front panel will show two numbered values displayed in °C for the channel. The Top number T= is the actual column enclosure temperature. The bottom number S= is the column temperature set point.

Operation

Depress the MENU button on the front panel to enter the temperature setting mode. Use the set point adjustment arrow buttons to raise and lower the desired set point per heating channel. Pressing the up or down arrow button alone will not change the set point value.

Depressing the MENU button will cycle through set point zero, remote 1, and remote 2.

Set the temperature to 35°C, after a few moments the column enclosure temperature will begin to rise as indicated by the T= display. Allow the column heater to reach 35°C and verify that the column heater will control properly. The set temperature will equilibrate quickly. Upon successful evaluation, set the heater to the desired control temperature.

Use and Care

The Column Heater is engineered to be lightweight and efficient. The materials used in fabricating the heater and controller sections may be sensitive to solvents. Proper installation includes reliable leak testing before installing the heater for each use. Do not immerse or operate any part of the Column Heater in liquids. In the event of solvent leakage, wipe sleeve down with clean paper towel before further use.

The **Temperature Control Module** is custom designed to offer optimum performance in heating applications. It has fast 100Hz sampling that improves control responsiveness, variable time base burst firing that increases the heater life and gives better temperature controllability, and a compact size which allows it to be placed in small areas.

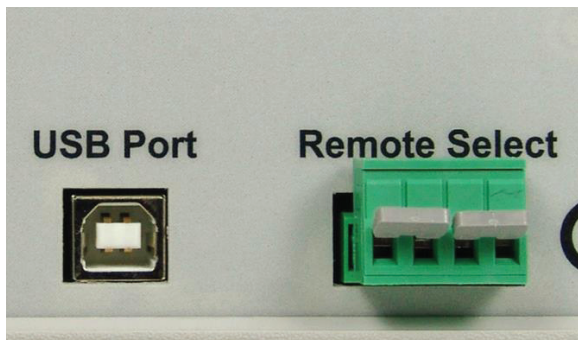

External Control

Your controller is equipped with an external control feature. The first is through USB 2.0 control with the supplied Graphical User Interface (GUI) software provided on the CD. The second is through contact closures from an outside source, i.e, autosampler, pump, etc. Attach leads to the supplied Green plug. Once contact is established at the other end of the leads, the controller will automatically disengage or engage heating values.

Remote Graphical User Interface (GUI)

Along with your MonoSLEEVE you also received a CD containing a graphical user interface which will allow you to control each channel from a computer should you wish to.

Place the GUI CD into your computer. You may transfer the program to your workstation or start the program directly from the CD. Plug in the USB cable and start-up the program and the interface at the right will appear.

Select AUTO to initialize the port. All current programmed information will appear within the display.

Select Auto Port or enter port manually if known. COMM Port (COM1 is default) and When communication is established, COMM OK will be shown.

ANALYTICAL SALES 5R7-528

PC Communications

Auto Port Selection

Manual Port Selection

Select Port

Message

Firmware Revision

SETUP

Set Temp 0

Set Temp 1

Set Temp 2

SEND SETUP

SENSOR TEMPERATURE

OUTPUT%

SET TEMPERATURE

CURRENT COUNTS

PCB TEMP

SENSOR ERROR STATUS

HIGH TEMP ALARM

CURRENT LIMITING

PCB OVER TEMP

This area indicates values from the front of the controller only.

MonoSLEEVE will operate with any of the following smart heaters:

HOT SLEEVE “Tube Style Heaters”

Cat. No.	Description
HSI-5L	HotSLEEVE Plus, 5cm Self-calibrating Column Heater
HSI-10L	HotSLEEVE Plus, 10cm Self-calibrating Column Heater
HSI-15L	HotSLEEVE Plus, 15cm Self-calibrating Column Heater
HSI-25L	HotSLEEVE Plus, 25cm Self-calibrating Column Heater
HSI-30L	HotSLEEVE Plus, 30cm Self-calibrating Column Heater

AgileSLEEVE Capillary Heaters

Cat. No.	Description
ASI1032H	AgileSLEEVE Plus, 10cm x 1/32" ID Self-calibrating Heater
ASI1016H	AgileSLEEVE Plus, 10cm x 1/16" ID Self-calibrating Heater
ASI1532H	AgileSLEEVE Plus, 15cm x 1/32" ID Self-calibrating Heater
ASI1516H	AgileSLEEVE Plus, 15cm x 1/16" ID Self-calibrating Heater
ASI2532H	AgileSLEEVE Plus, 25cm x 1/32" ID Self-calibrating Heater
ASI2516H	AgileSLEEVE Plus, 25cm x 1/16" ID Self-calibrating Heater
ASI3032H	AgileSLEEVE Plus, 30cm x 1/32" ID Self-calibrating Heater
ASI3016H	AgileSLEEVE Plus, 30cm x 1/16" ID Self-calibrating Heater

DECLARATION OF CONFORMITY

Analytical Sales and Services, Inc. hereby declares that the product(s) listed below conform to the European Union directives and standards identified in this declaration.

Analytical Sales and Services, Inc. erklärt, daß die aufgeführten Produkt(e) in Übereinstimmung sind mit den Bestimmungen der angegebenen EU-Richtlinien und mit den aufgeführten normative Dokumenten.

Analytical Sales and Services, Inc. dichiara con la presente, che i prodotto(i) sottomenzionati sono in conformità con le direttive e norme Europee, specificate in questa dichiarazione.

Analytical Sales and Services, Inc. déclare par la présente, que les produit(s) sous-mentionnés, sont conformes aux directives et normes Européennes identifiées dans cette déclaration.

Analytical Sales and Services, Inc. declara por la presente que los producto(s) abajo mencionados, están conformes con las directivas y normas Europeas identificadas en esta declaración.

Products(s) / Produkt(e) / Prodotto(i) / Produit(s) / Producto(s):

MonoSLEEVE HPLC HEATERS

EU Directive(s) / EU-Richtlinien / Direttiva(e) Europea / Directives Européenne(s) / Directiva(s) Europeas:

Low Voltage (73/23/EEC, 93/68/EEC)

Electromagnetic Compatibility (89/336/EEC, 92/31/EEC, 93/68/EEC)

Standard(s) / Norm(en) / Norma(e) / Norme(s) / Norma(s):

EN55011:1998 ENN61000-3:1995+A1:1998+A2:1998+A14:2000

EN61326: 1997 +A1: 1998 +A2:2000 EN61000-3-3:1995

EN61010-1:2001

**For technical support or to reorder supplies,
contact Analytical Sales & Services, Inc.**

MonoSLEEVE is a trademark of
Analytical Sales & Services, Inc.



179 Route 206
Flanders, NJ 07836

Phone: 973-616-0700
Fax: 973-6160133

Email: info@analytical-sales.com
Web site: www.analytical-sales.com
Online Store: www.analytical-sales.biz